

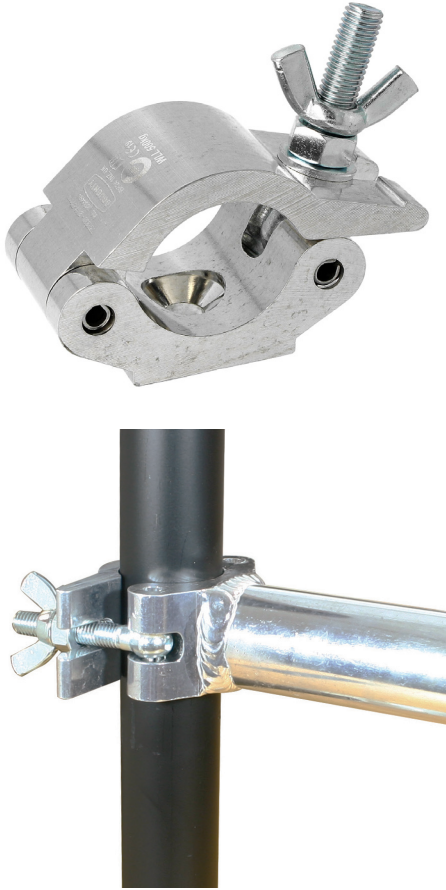

Product Data Sheet

Low Profile Weld Coupler



A low profile coupler used for special applications where welding is required.

Part Nos	T57230 - Polished
Tube Diameter	Ø48 - 51mm
Materials	Main Body - AW6082 T6 Aluminium Roll Pins - Stainless Steel Eyebolt Assy - Grade 8.8
Max Tightening Torque	30Nm
Fixings	N/A
WLL	N/A (due to welding)
Weight	0.49Kg
Factor of Safety	N/A
Approval	N/A (due to welding)

